

Parts

- Model 287030 Cleanshot™ Shut-off Valve
- Model 244161 Contractor™ In-line Gun (North America)
- Model 244364 Contractor™ In-line Gun (Europe)
- Model 244365 Contractor™ In-line Gun (Asia)

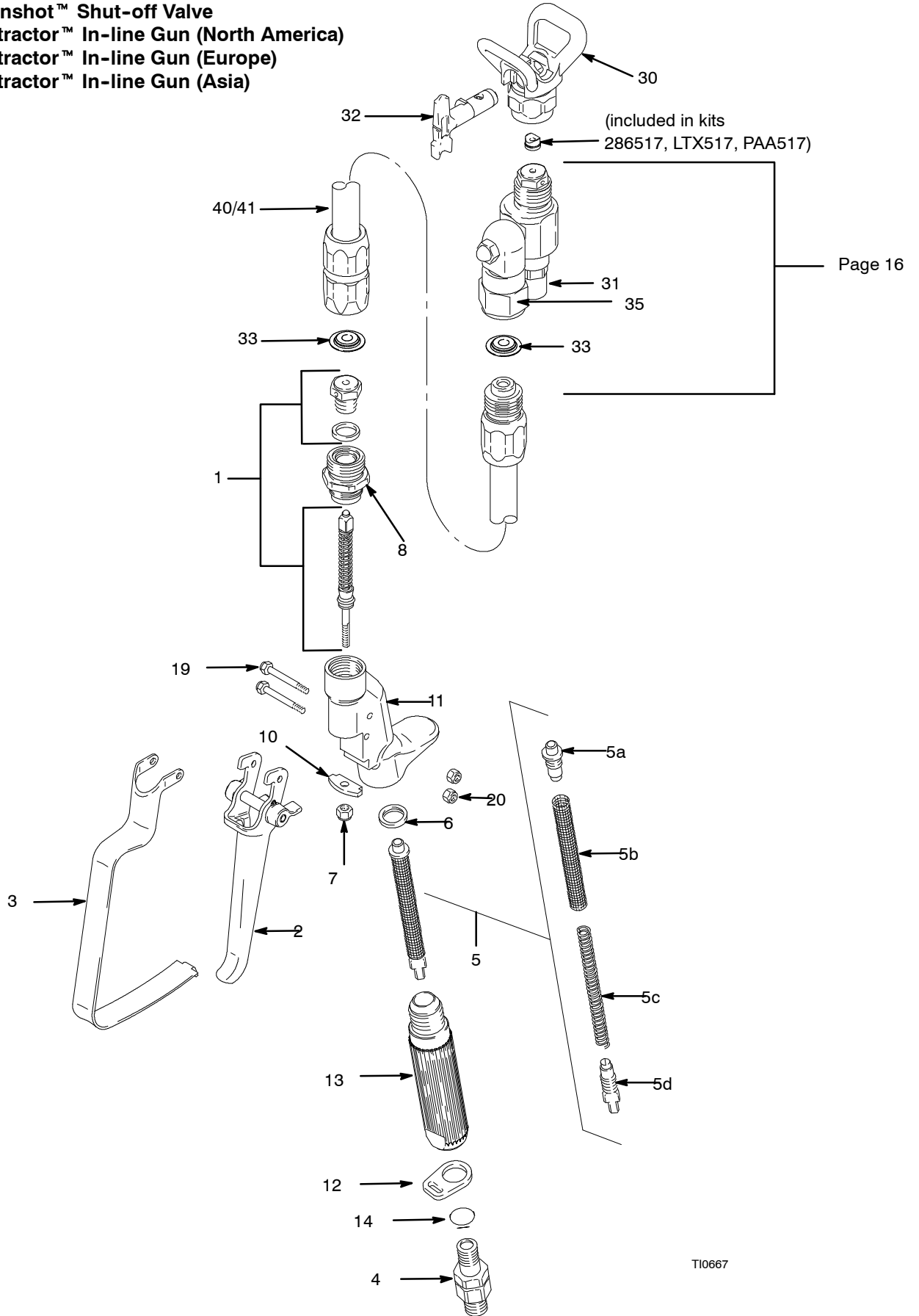

T10667

Parts

Cleanshot™ Repair Kit 244162 (31)
 Swivel Repair Kit 244363 (35)†
 Valve Body Repair Kit 245687 (36)*†

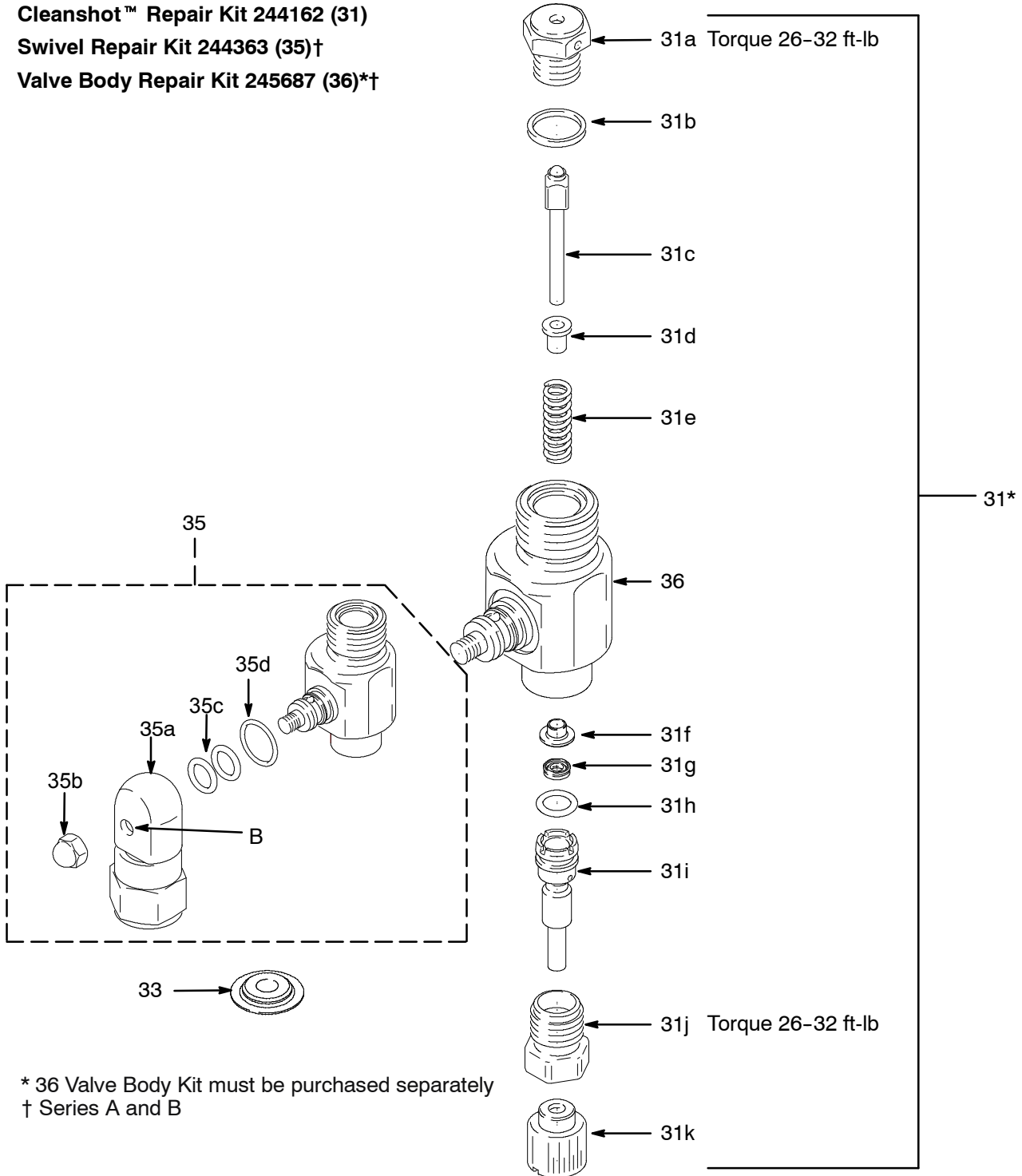

* 36 Valve Body Kit must be purchased separately
 † Series A and B

ti0947

Parts List

Model 287030 Cleanshot™ Shut-off Valve
Model 244161 Contractor™ In-line Gun (North America)
Model 244364 Contractor™ In-line Gun (Europe)
Model 244365 Contractor™ In-line Gun (Asia)

Ref. No.	Part No.	Description	Qty.	Ref. No.	Part No.	Description	Qty.
1	218070	NEEDLE-DIFFUSER/SEAT KIT	1	30	243161	HandTite™ Guard	1
2	244193	TRIGGER, gun, inline	1			See Manual 309055 for other tip sizes	
3	196869	GUARD, trigger	1		246215	Guard, RAC 5, (Asia)	1
4	238817	KIT, swivel	1	31	244162	KIT, Cleanshot™ repair includes parts 31a-31k	1
5✓	218131	FLUID FILTER ASSEMBLY (standard 50 mesh) includes replacement parts 5a, 5b, 5c, 5d	1	31a		SEAT, valve	1
5a	179722	RETAINER, spring	1	31b	156766	GASKET	1
5b	179731	ELEMENT, strainer	1	31c		RETAINER, ball	1
5c	179763	SPRING, compression	1	31d		DAMPENER, spring	1
5d	179750	RETAINER, spring	1	31e		SPRING, compression	1
6✓	179733	SEAL, sleeve	1	31f		GUIDE, spring	1
7	107110	LOCKNUT	1	31g	116566	SEAL, u-cup	1
8	197052	ADAPTER, RAC	1	31h	113137	PACKING, o-ring	1
10	197058	BRACKET, stem	1	31i		RETAINER, u-cup	1
11	197568	HOUSING, fluid, locking (North America/Asia)	1	31j		CAP, end, u-cup	1
	196828	HOUSING, fluid (Europe)	1	31k		KNOB, valve	1
12	113409	RETAINER, guard	1	32✓		SWICHTIP, size 517	1
13	195788	HANDLE, gun (North America/Europe)	1		286517	RAC 5, (Asia)	1
	243393	HANDLE, gun (Asia)	1		LTX517	RAC X, latex (North America/Asia)	1
14	104938	PACKING, o-ring	1		PAA517	RAC X, latex, (Europe)	1
19	177538	STUD, trigger	2	33	15H622	GASKET	1
20	105334	NUT, lock, hex	2	35	244363	KIT, swivel repair, includes 35a - 35d	1
21▲	222385	WARNING CARD (not shown)	1	35a	244663	SWIVEL, inlet assembly	1
23▲	187348	COVER, warning	1	35b	120189	NUT, cap	1
				35c	107505	PACKING, o-ring	2
				35d	109576	PACKING, o-ring	1
				36	245687	KIT, Valve body	1
				40●	244163	3-FOOT POLE	1
				41●	244164	6-FOOT POLE	1

▲ Replacement Danger and Warning labels, tags and cards are available at no cost.

✓ Keep these spare parts on hand to reduce down time.

● Part number provided for reference only. Not available as a replacement part.